

# True Wireless™ Accessories

User Guide



*Hear now. And always*



This document contains information on how to use the Cochlear™ True Wireless™ Accessories with the following sound processors:

- Cochlear Nucleus® **CP900 Series Sound Processors**
- Cochlear Nucleus **Kanso™ Sound Processor**
- Cochlear **Nucleus 7 Sound Processor**.

Read this document carefully, and the other user guides it refers to, to ensure that you understand how to use these accessories with your system.

## Symbols



**NOTE**  
Important information or advice.



**TIP**  
Time saving hint.



**CAUTION (no harm)**  
Special care to be taken to ensure safety and effectiveness.  
Could cause damage to equipment.



**WARNING (harmful)**  
Potential safety hazards and serious adverse reactions.  
Could cause harm to person.

---

# Contents

About this guide.....	2
Wireless accessories.....	4
Getting started.....	5
Mini Microphone 2 & Mini Microphone 2+.....	6
Operating characteristics.....	6
Preparing for use.....	8
Step 1: Pair your Mini Microphone.....	10
Step 2: Stream audio from your Mini Microphone.....	12
Using your Mini Microphone.....	16
Volume control.....	17
Additional features - Mini Microphone 2+.....	20
TV Streamer.....	22
Operating characteristics.....	22
Step 1: Pair your TV Streamer.....	23
Step 2: Stream audio from your TV Streamer.....	26
Volume control.....	30
Adjustable delay mode.....	31
Phone Clip.....	32
Operating characteristics.....	32
Charge your Phone Clip.....	33
Step 1: Pair your Phone Clip.....	34
Step 2: Use your Phone Clip.....	36
Using multiple accessories.....	38
To pair multiple wireless accessories.....	39
To stream audio with multiple wireless accessories.....	39
Check the wireless microphone performance.....	40
Change the accessory mixing ratio.....	42
Cautions.....	43
Warnings.....	44
Magnetic resonance imaging (MRI).....	44
Care and maintenance.....	45
Certification.....	47
Legal statement.....	47

## About this guide

This guide is intended for use by Cochlear implant recipients using the following systems:

### CP900 SERIES AND KANSO

#### CP900 Series and Kanso Sound Processors



#### Remote Control (CR210)



#### Remote Assistant (CR230)



## NUCLEUS 7



Use this guide along with the user guides for your sound processor, remote or the app.

Also refer to the user guide that was packaged with your wireless accessory.

This guide describes how to set up and use your Cochlear True Wireless Accessories. Before doing this, we recommend you read *Wireless accessories* on page 4 to help you understand what each accessory does and the two main steps that get you up and running.

## Wireless accessories

The Cochlear True Wireless Accessories enhance the performance of your Cochlear system by wirelessly transmitting sound from audio sources to your sound processor.



### NOTE

See pages 43 and 44 for Cautions and Warnings relating to use of your wireless accessory.

**The Cochlear Wireless Mini Microphones** provide simple and discreet one-to-one hearing or versatile functionality for noisy or challenging listening situations.



**The Cochlear Wireless TV Streamer** transmits sound directly from your TV, sound system or computer.



**The Cochlear Wireless Phone Clip** wirelessly connects to Bluetooth® devices, for example, mobile phones, music players and navigation systems.



## Getting started

Using your wireless accessory for the first time is a two-step process—pair, stream:

### Step 1: Pair

Pair your wireless accessory with your sound processor(s) so they can communicate (you only need to do this the first time).

### Step 2: Stream

Streaming lets you transmit audio from your wireless accessory to your sound processor.

## Mini Microphone 2 & Mini Microphone 2+

The Cochlear Wireless Mini Microphone 2 and Mini Microphone 2+ (from now on referred to as your Mini Microphone) allow you to stream audio directly to your sound processor. The Mini Microphone 2+ also provides additional functionality.

### Operating characteristics

CHARACTERISTIC	VALUE/RANGE	MINI MICROPHONE	
		2	2+
One-to-one communication	Operating range up to 25 m	✓	✓
Talk time before recharge required	Approx 10 hours	✓	✓
Reconnect time window if connection lost	5 minutes	✓	✓
Volume lock		✓	✓
Mute function		✓	✓
Built-in drop detection feature	From heights > 75 cm. Mutes output for up to 2 seconds	✓	✓
Multi-use functionality	Table mic, Line-in, Induction-loop and FM signals		✓





## Preparing for use

### Charge your Mini Microphone

When using for the first time, allow your Mini Microphone to charge for at least 3 hours, even if the light indicates a full charge.

#### To charge your Mini Microphone:

1. Plug the micro-USB charging cable into the Mini Microphone.
2. Plug the other end into a power outlet using the supplied adaptor.
3. While charging, the LED indicator lights red.
4. When fully charged (and still connected to the charger), the LED lights red with green flashes every 2 seconds.

If battery level is low the Status indicator LED blinks yellow once every second.



Mini Microphone 2 charging



Mini Microphone 2+ charging



#### NOTE

Remember to turn off your Mini Microphone when not in use, and keep it charged. Battery life (talk time) is 10 hours.

## Power ON/OFF your Mini Microphone

### To power ON your Mini Microphone:

1. Press and hold the **ON/OFF** button for **2 seconds** until the LED turns green.
2. Release the **ON/OFF** button. The LED blinks green every 2 seconds.



### To power OFF your Mini Microphone:

1. Stop streaming before you turn off the Mini Microphone.
2. Press and hold the **ON/OFF** button until the LED turns red.

## Step 1: Pair your Mini Microphone

You first need to pair your Mini Microphone with your sound processor(s), so they can communicate.



### NOTE

If you want to pair more than one wireless accessory to your sound processor, you need to use separate 'channels'. See Using multiple accessories on page 38 for an explanation.

### To pair your Mini Microphone:

1. Remove your sound processor(s).
2. Turn **OFF** your sound processor(s).
3. Turn **ON** your Mini Microphone by pressing and holding the **ON/OFF** button on your Mini Microphone for **2 seconds** until the LED turns green.
4. Use a pen to press the pairing button once. The LED on top of the Mini Microphone blinks yellow once every 2 seconds for 20 seconds. You must turn on your processor(s) during this 20 second window to pair it with the Mini Microphone.



Mini Microphone 2

Mini Microphone 2+

5. Turn **ON** your sound processor(s). It briefly flashes a blue indicator light  to tell you pairing has been successful.
6. You can now replace your sound processor(s).



**NOTE**

After pairing, if you are not wearing your sound processor, the blue flashing light will change to orange.

## Step 2: Stream audio from your Mini Microphone

To hear sound from your Mini Microphone you need to stream audio.

There are 4 ways you can do this:

USE YOUR...	CP900 SERIES	NUCLEUS 7
1 Sound processor button	✓	✓
2 Remote Control	✓	✓
3 Remote Assistant	✓	-
4 Nucleus Smart App	-	✓

Once streaming has been activated, audible beeps or a flashing light (depending on your sound processor) are followed by streamed audio.

When stopping streaming, you hear a short beep. Your sound processor returns to the last program used.

### Option 1: Use your sound processor(s)

1. Turn **ON** your sound processor(s).
2. Turn **ON** your Mini Microphone.
3. **Press and hold** the button on your sound processor for 2 seconds, **then release**. Your sound processor flashes a blue light  to indicate streaming.



#### NOTE

For processors with two buttons, use the top button.

4. To stop streaming, **tap** the button on your sound processor.

## Option 2: Use your Remote Control

1. Turn **ON** your sound processor(s).
2. Turn **ON** your Remote Control.
3. Turn **ON** your Mini Microphone.
4. **Press and hold** the Telecoil button for 2 seconds, **then release**.



5. To stop streaming, **tap** the Telecoil button.



### NOTE

Screen features may differ between products. See the user guide that came with your device for product-specific details.

### Option 3: Use your Remote Assistant

1. Turn **ON** your sound processor(s).
2. Turn **ON** your Remote Assistant. The **Home** screen displays.
3. Turn **ON** your Mini Microphone.
4. You can start streaming with your Remote Assistant in two ways:
  - **Method 1: Press and hold** the Telecoil button for **2 seconds**, then release.



Your Mini Microphone displays as an icon on the **Home** screen:

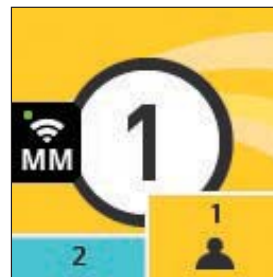

- **Method 2:** From the **Home** screen, press the right arrow button until you see the **Stream** selector screen. Scroll down the list to the channel you want to use and press **OK**.





5. To stop streaming, either:
  - **Tap** the Telecoil button, or
  - Select **OFF** on the **Stream** selector screen then press **OK**.



#### Option 4: Use the Nucleus Smart App

1. Turn **ON** your sound processor(s).
2. Turn **ON** your Mini Microphone.
3. **Start** the app.
4. Tap **Audio Sources** and tap the **Mini Mic** icon. Your sound processor flashes a blue light  to indicate streaming. The **Mini Mic** streaming icon displays on the app.

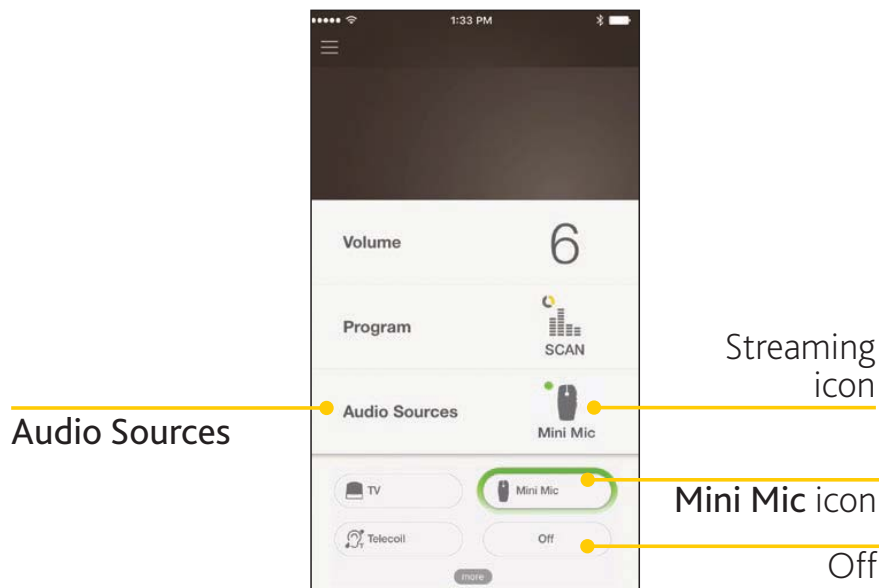

5. To stop streaming, tap **Off** or **X** on the app screen.

## Using your Mini Microphone

### One-to-one communication

A speaker can wear the Mini Microphone by clipping it to their clothing in a vertical position within 10-40 cm of their mouth. Your Mini Microphone provides direct one-to-one communication with minimal background noise.



#### NOTE

Make sure the ON/OFF button on top of the Mini Microphone is pointing towards the speaker's mouth when worn this way.

### Use as a table microphone (2+ only)

When placed horizontally on a table, your Mini Microphone 2+ automatically switches from directional mode (for one-to-one communication) to omnidirectional mode to pick up the voices of multiple speakers.

### Test your Mini Microphone

Tap on or blow into the Mini Microphone to test that it is streaming. If you don't hear anything at first, you may need to turn up the volume on your Mini Microphone.

## Volume control

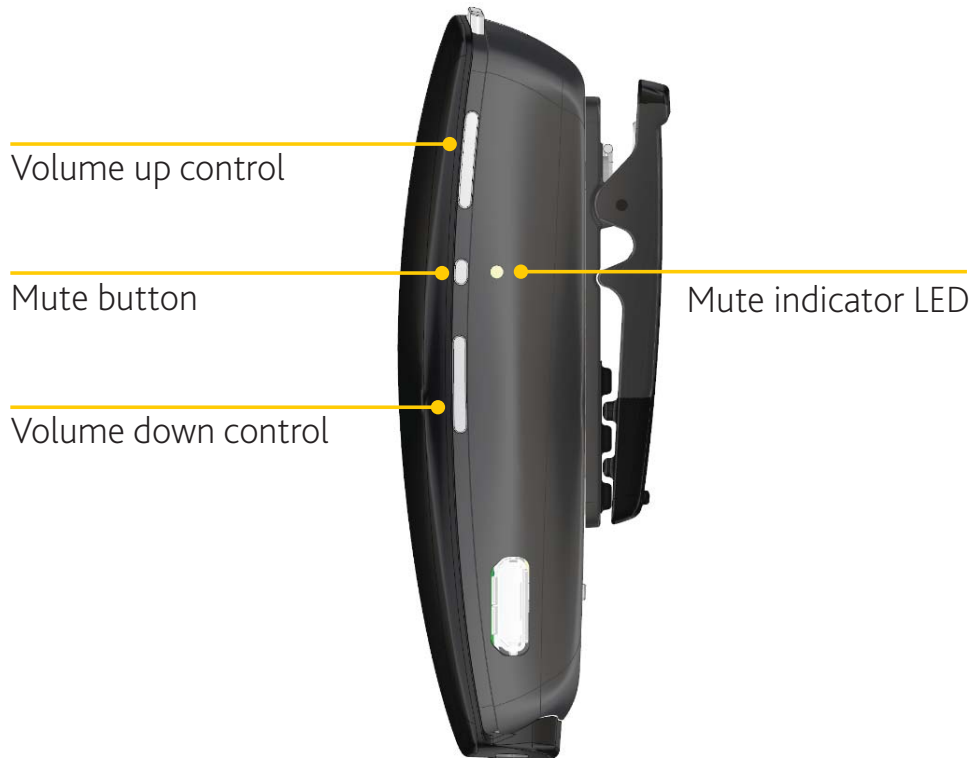

### Adjust the volume

To change the volume, use the volume controls on the side of your Mini Microphone.

### Mute the volume

The audio from the Mini Microphone can be muted, for example if the speaker needs to have a separate conversation that is not relevant to the user.

To mute the signal, press the **Mute** button (located between the volume controls) once. The Mute LED flashes yellow. To unmute, press again. The Mute LED stops flashing.

## Lock the volume

The volume can be locked to a specific level. When locked, the volume remains fixed at the level that was set when the Mini Microphone was last turned off.

### To lock the volume:

1. While streaming from your Mini Microphone, adjust the volume to your desired level.
2. Turn **OFF** your Mini Microphone.
3. **Press and hold** the volume '-' button together with the **ON/OFF** button.
4. When the Status indicator LED turns green, keep holding the volume '-' button and **release** the **ON/OFF** button.
5. Continue holding the volume '-' button (for about 10 seconds), until the Status indicator LED displays a green-yellow-red sequence.

Your volume level is now locked and will remain at this level even after switching the Mini Microphone off and on. The Status indicator LED gives two quick flashes every two seconds.



#### NOTE

You can still Mute audio while the volume is locked.

### To unlock the volume:

1. Turn **OFF** your Mini Microphone.
2. **Press and hold** the volume '+' button together with the **ON/OFF** button.
3. When the Status indicator LED turns green, keep holding the volume '+' button and **release** the **ON/OFF** button.
4. Continue holding the volume '+' button (for about 10 seconds), until the Status indicator LED displays a green-yellow-red sequence.

Your volume level is now unlocked and can be adjusted as required.

## Additional features - Mini Microphone 2+

The Mini Microphone 2+ has extra connectivity options. You can also stream speech and audio:

- from the built-in microphones
- from the built-in Telecoil, receiving audio from an induction loop system
- from an external FM receiver attached via the built-in 3-pin Euro pin connector
- from an external, analogue source (PC, laptop, TV etc) connected via the built-in Line-in connector.

### Using the Mode button

The Mode button is used to view the current mode, switch between input modes and check the battery status.

To view the current mode of operation, press the **Mode** button (on the back of the Mini Microphone 2+) once. The current mode's LED lights up for 2 seconds.

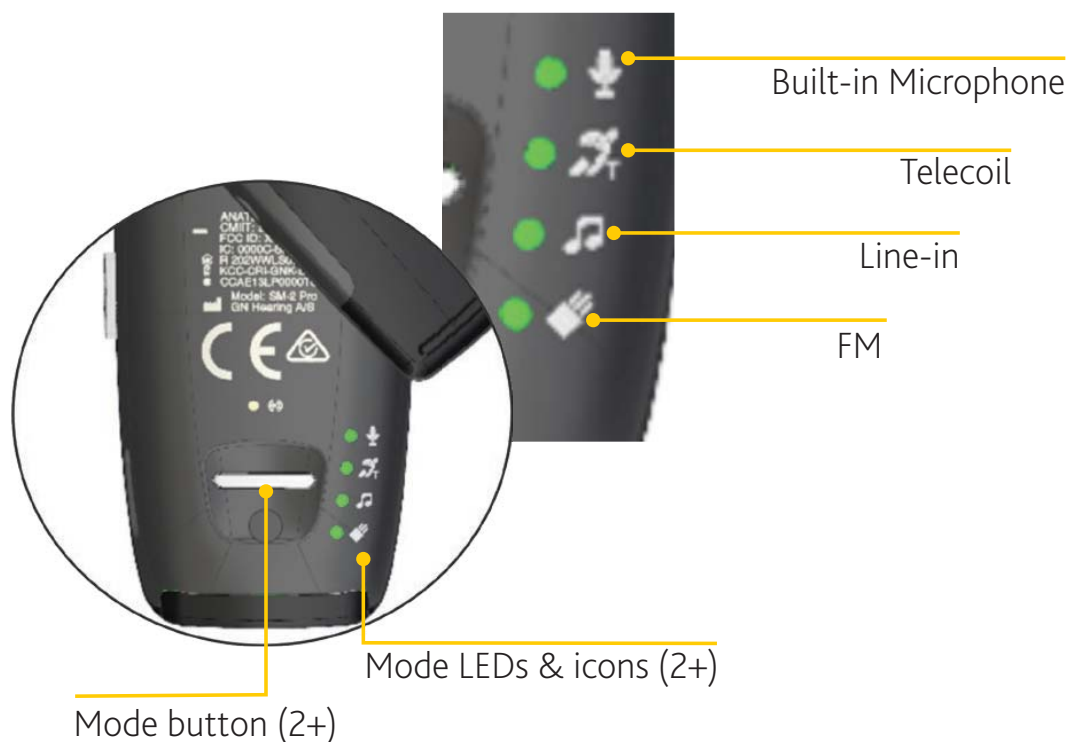

## To change the mode of operation:

1. Press the **Mode** button once. The Mode LED corresponding to the current mode lights up.
2. Within 3 seconds, press the **Mode** button again to change mode.
3. Repeat Step 2 until the desired mode is selected. The new mode will operate when the LED turns off after 3 seconds.

For further details on mode functions, refer to the user guide that was packaged with your Mini Microphone 2+.

## Battery Status

To view the current battery status, press and hold the **Mode** button for about 3 seconds or until one or more of the Mode LEDs start to blink.

REMAINING BATTERY CAPACITY	LED STATUS
75-100%	All Mode LEDs blink
50-75%	Three Mode LEDs blink (FM + Line-in + Telecoil)
25-50%	Two Mode LEDs blink (FM + Line-In)
< 25%	One Mode LED blinks (FM)

## TV Streamer

The Cochlear Wireless TV Streamer streams stereo sound directly from your TV, sound system or computer to your sound processor.



\* Cables not supplied

## Operating characteristics

CHARACTERISTIC	VALUE/RANGE
Operating range	At least 7 metres
Reconnect time window if connection lost	5 minutes



## Step 1: Pair your TV Streamer

You first need to pair your TV Streamer with your sound processor(s), so they can communicate.



### NOTE

If you want to pair more than one wireless accessory to your sound processor, you need to use separate 'channels'. See Using multiple accessories on page 38 for an explanation.

### To pair the TV Streamer:

1. Plug the power cable into the micro-USB socket on your TV Streamer and connect it to a wall power outlet.
2. Plug the audio cable into the mini-jack audio input socket on your TV Streamer and connect it to the audio source.



Typical connection to  
TV or stereo



Typical connection to set top box  
(Scart terminal)



Typical connection to  
computer headphone terminal



#### NOTE

Some connections may result in only you being able to hear the audio. For example, if you connect into a headphone socket on your TV or audio device.

Check your TV's user guide for set up options that allow you and others to hear the TV at the same time.

3. The TV Streamer power indicator lights green.
4. Remove your sound processor(s).
5. Turn **OFF** your sound processor(s).

6. Press the pairing button on your TV Streamer once.  
The activity light flashes orange for 20 seconds. You must turn on your processor during this 20 second window to pair it with the TV Streamer.
7. Turn **ON** your sound processor(s). It briefly flashes a blue indicator light  to tell you pairing has been successful.



**NOTE**

After pairing, if you are not wearing your sound processor, the blue flashing light will change to orange.

8. You can now replace your sound processor(s).

To hear sound via your TV Streamer you need to stream audio.

Go to *Step 2: Stream audio from the TV Streamer.*

## Step 2: Stream audio from your TV Streamer

To hear sound from your TV Streamer you need to stream audio.

There are 4 ways you can do this:

USE YOUR...	CP900 SERIES	NUCLEUS 7
1 Sound processor button	✓	✓
2 Remote Control	✓	✓
3 Remote Assistant	✓	-
4 Nucleus Smart App	-	✓

Once streaming has been activated, audible beeps or a flashing light (depending on your sound processor) are followed by streamed audio.

When stopping streaming, you hear a short beep. Your sound processor returns to the last program used.

### Option 1: Use your sound processor

1. Turn **ON** your sound processor(s).
2. Turn **ON** your TV Streamer.
3. **Press and hold** the button on your sound processor for 2 seconds, **then release**. The sound processor flashes a blue light  to indicate audio is streaming.



#### NOTE

For processors with two buttons, use the top button.

4. To stop streaming, **tap** the button on your sound processor.

## Option 2: Use your Remote Control

1. Turn **ON** your sound processor(s).
2. Turn **ON** your Remote Control.
3. Turn **ON** your TV Streamer.
4. **Press and hold** the Telecoil button for 2 seconds, **then release**.



5. To stop streaming, **tap** the Telecoil button.

### Option 3: Use your Remote Assistant

1. Make sure your audio source (computer, stereo, TV, etc.) is turned **ON**.
2. Turn **ON** your sound processor(s).
3. Turn **ON** your Remote Assistant. The **Home** screen displays.
4. Turn **ON** your TV Streamer.
5. You can start streaming in two ways:
  - **Method 1: Press and hold** the Telecoil button for 2 seconds, **then release**. This streams audio from channel 1.



Your TV Streamer displays as an icon on the **Home** screen:



- **Method 2:** From the **Home** screen, press the right arrow button until you see the **Stream** selector screen. Scroll down the list to the channel you want to use and press **OK**.

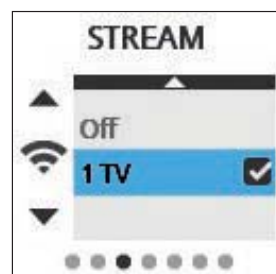
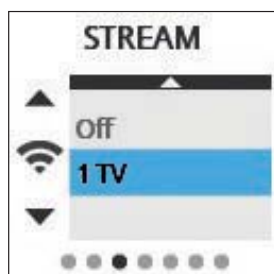

6. To stop streaming, either:
  - **Tap** the Telecoil button, or
  - Select **OFF** on the **Stream** selector screen then press **OK**.

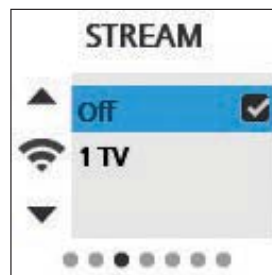

#### Option 4: Use the Nucleus Smart App

1. Turn **ON** your sound processor(s).
2. Turn **ON** your TV Streamer.
3. **Start** the app.
4. Tap **Audio Sources** and tap the **TV** icon. Your sound processor flashes a blue light  to indicate streaming. The **TV** streaming icon displays on the app.

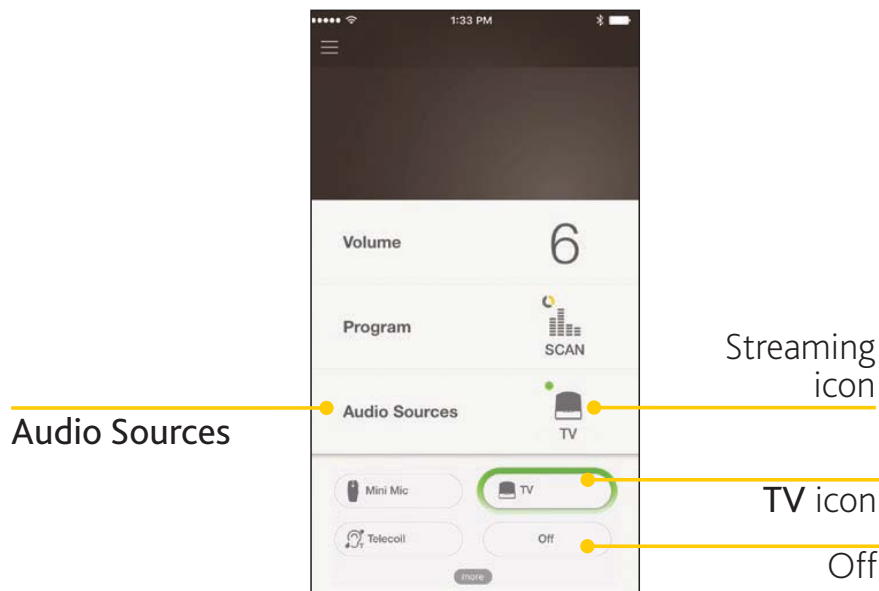

5. To stop streaming, tap **Off** or **X** on the app screen.

## Volume control

To adjust the volume, use the volume control on the TV Streamer. Depending on your TV / audio set up, this volume may be independent of the volume heard by others.

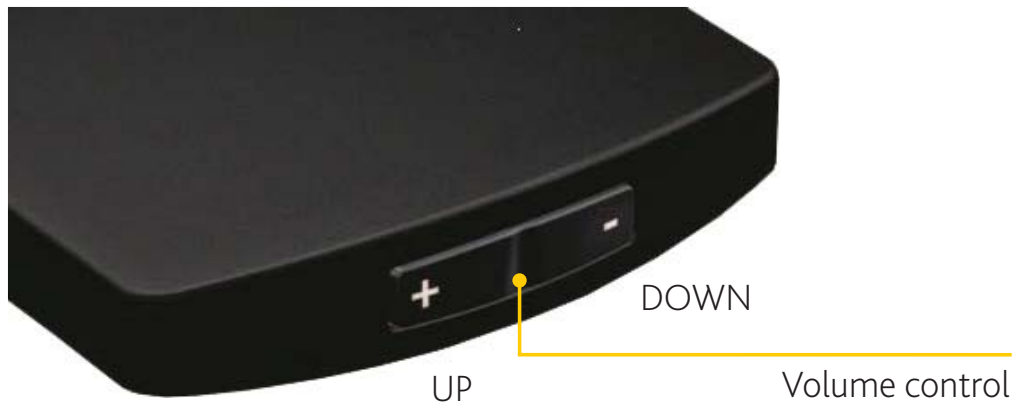



## Adjustable delay mode

In rare cases you may find a misalignment between:

- the audio streamed to your sound processors and the sound coming from the TV speakers (echo); or
- the streamed audio and the TV picture (lip-sync).

You can adjust the audio delay on your TV Streamer. See the user guide that was packaged with your TV Streamer for more information.

## Phone Clip

The Cochlear Wireless Phone Clip attaches to your clothing and allows you to wirelessly access Bluetooth® devices in situations such as:

- making hands-free calls on your mobile phone
- hearing a Bluetooth-enabled navigation system
- streaming music from a Bluetooth-enabled device.

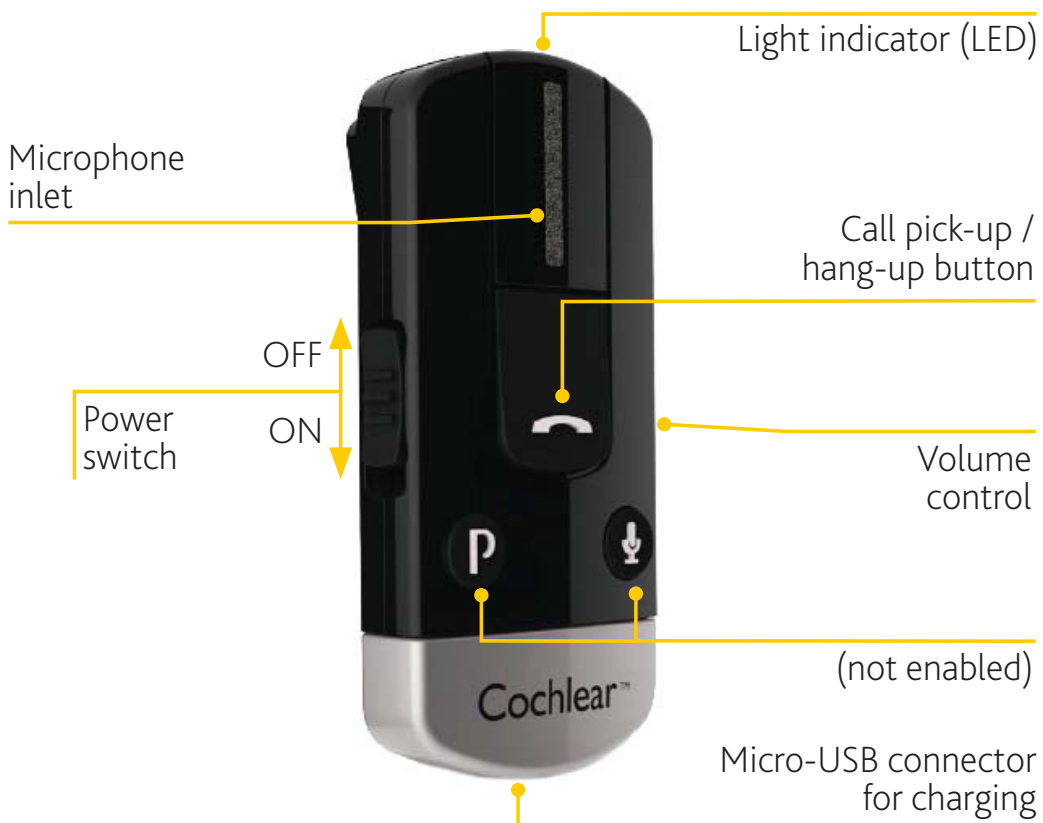

## Operating characteristics

CHARACTERISTIC	VALUE/RANGE
Operating range (processor to Phone Clip)	At least 3 metres
Operating range (phone to Phone Clip)	At least 7 metres
Talk time before recharge required	Approx. 6 hours
Reconnect time window if connection lost	30 seconds

## Charge your Phone Clip

1. Plug the micro-USB charging cable into the base of the Phone Clip.
2. Plug the other end into a power outlet using the supplied adaptor.

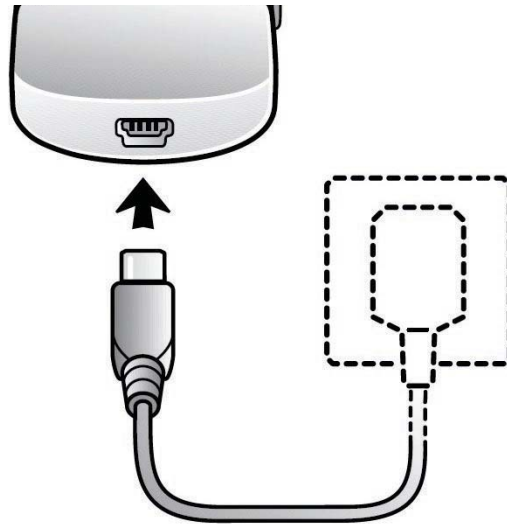

3. While charging, the LED on top of the Phone Clip lights red. When fully charged, it lights green with red flashes every 2 seconds.
4. The first time you charge your Phone Clip, allow it to charge for at least 3 hours, even if the light indicates a full charge.

If you receive a call, it overrides any current audio stream, and you can either answer or reject the call.



### NOTE

Remember to turn off your Phone Clip when not in use, and keep it charged. Nominal talk time is 6 hours for the Phone Clip (80 hours on standby).

## Step 1: Pair your Phone Clip

You first need to pair your Phone Clip with your sound processor(s), so they can communicate.

### Step 1a: Pair your sound processor to the Phone Clip:

1. Remove your sound processor(s).
2. Turn **OFF** your sound processor(s).
3. Turn **ON** your Phone Clip. The LED flashes green when it is turned on.
4. Remove the silver cover from the base of the Phone Clip by sliding it downwards.
5. Use a pen to press the white pairing button on the back of your Phone Clip. You now have 20 seconds to turn on your processor(s) in order to pair it with the Phone Clip.



#### NOTE

If you use a compatible GN ReSound hearing aid on one side and a Cochlear sound processor on the other, pair the hearing aid first, then the sound processor, in the same Phone Clip pairing window.

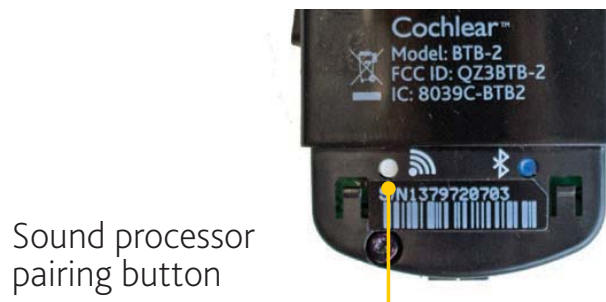

6. Turn **ON** your sound processor(s). It briefly flashes a blue light  to tell you pairing has been successful.



**NOTE**

After pairing, if you are not wearing your sound processor, the blue light will change to orange.

7. You can now replace your sound processor(s).

**Step 1b: Pair your mobile phone to the Phone Clip:**

8. Turn on Bluetooth on your mobile phone.
9. Press the blue pairing button on the back of the Phone Clip. The LED lights blue for 2 minutes. While it is blue, you need to pair the Phone Clip with your mobile phone.



Mobile phone pairing button

10. On your mobile phone, select the *Hearing Aid Phone* from the list of Bluetooth devices.
  11. Replace the silver cover on the base of the Phone Clip.
- Now you can use your Phone Clip. Go to *Step 2: Use your Phone Clip*.

## Step 2: Use your Phone Clip

### For phone calls:

- **Answer a call:** press the Call pick-up/hang-up button.
- **Reject a call:** double-press the Call pick-up/hang-up button.
- **Make a call:** Press and hold the Call pick-up/hang-up button for 2 seconds, then release. Use voice commands to make a call.
- **Finish a call:** tap the Call pick-up/hang-up button.

You can also use your phone as normal to make, answer and finish phone calls. The only difference is that sound will be streamed automatically to your sound processor(s).



#### TIP

For best performance wear your Phone Clip vertically within 30 cm of your mouth. The Phone Clip comes with a pivoting clip so you can easily rotate it to a vertical position.



#### NOTES

- For more advanced features, see the user guide that was packaged with your Phone Clip.
- You may hear a beep whenever an audio signal comes into the Phone Clip (e.g. if you receive an SMS). You may be able to disable this using the silent mode on your phone or by turning off phone notifications. See your phone user guide.

A Phone Clip that is streaming displays as a Bluetooth icon on your Remote Assistant **Home** screen:



### Stream music (from a Bluetooth-enabled device):

1. Connect (pair) the device (for example, mobile phone or computer) to the Phone Clip using Bluetooth.
2. Start playing music on the device.  
You will hear audio playing in your sound processor.
3. To stop streaming, stop playing music on the device.



#### TIP

To change the volume, use the controls on the Phone Clip.



## Using multiple accessories

You can pair your sound processor to more than one wireless accessory. Each accessory needs to be allocated its own 'channel':

- Your sound processor has 3 channels that can be paired to a Mini Microphone or TV Streamer.
- If you have already paired a wireless accessory as shown in this guide, it will be in channel 1.
- To pair to another accessory, you must select a free channel.



### TIP

Use your Remote Assistant's Stream selector screen to display which channels are already allocated.

In this example, the Remote Assistant's **Stream** selector screen shows a Mini Microphone paired to channel 1 and a TV Streamer paired to channel 2.



### NOTE

The Phone Clip uses its own dedicated channel, so you do not need to select a channel when pairing and it will never be listed on the Stream selector screen.



## To pair multiple wireless accessories

If you want to pair to a Mini Microphone or TV Streamer, you must select a free channel (or the newly paired accessory will replace the existing one):

- If your sound processor is not paired to any wireless accessories, then press the pairing button on your wireless accessory 1 time to pair to channel 1.
- 2 presses for channel 2.
- 3 presses for channel 3.

## To stream audio with multiple wireless accessories

If your wireless accessory is paired in:

- **Channel 1: Press and hold** the button on your sound processor for 2 seconds, **then release**. The sound processor flashes a blue light  to indicate audio is streaming.
- **Channel 2: Press and hold** the button on your sound processor for 2 seconds, **then release** to start streaming. **Repeat** to stream from channel 2.
- **Channel 3: Press and hold** the button on your sound processor for 2 seconds, **then release** to start streaming. **Repeat twice** to stream from channel 3.

To stop streaming, **tap** the button on your sound processor.

## Check the wireless microphone performance

Remote Assistant users can measure and compare the signal level received from your sound processor microphones with the signal received from a remote microphone such as Mini Microphone (MM) or FM device.

This measurement can be helpful to:

- set up an FM system
- check that the remote microphone is still providing the desired benefits.

You can display this “Advantage” screen on your Remote Assistant by following these steps:



### NOTE

Before following the steps below it is important to choose a quiet place with no background noise.

1. On your Remote Assistant, from the **Home** screen, press the right arrow button until you get to the **Settings** screen then press the **OK** button.
2. Press the right arrow button until you get to the **MM/FM Advantage** screen. Press **OK**.

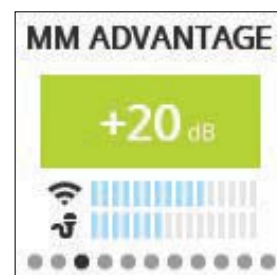

The MM/FM Advantage screen has three main elements:

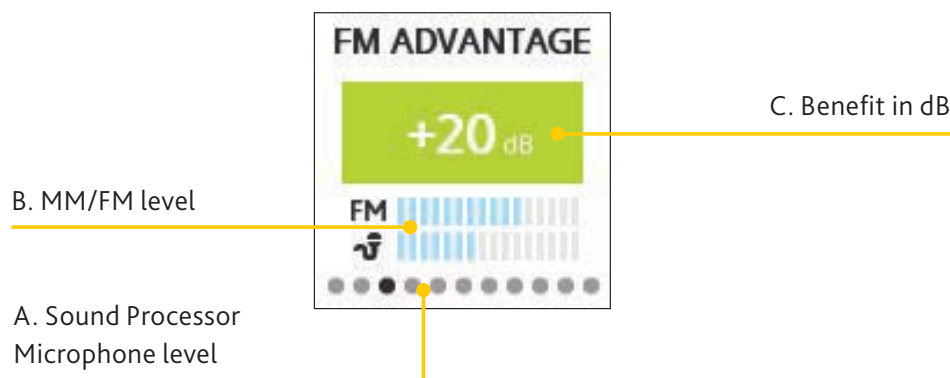

- A. The **Sound Processor Microphone level** bar graph at the bottom.
- B. The **MM/FM level** bar graph in the middle. This is the wireless accessory sound level.
- C. The difference between the remote microphone input and the processor microphone input, measured in decibels (dB). This number shows the **benefit in dB** the user is getting from the remote microphone. If the number is a negative value, then the remote microphone volume may need to be adjusted or there may be too much background noise during the measurement.

# Change the accessory mixing ratio

## Option 1: Use your Remote Assistant



### NOTE

You can only do this using your Remote Assistant in Advanced Mode.

To adjust the audio mixing ratio between the wireless accessory and your sound processor microphones:

1. On your Remote Assistant, from the **Home** screen, press the right arrow button until you reach the **Settings** screen and press the **OK** button.
2. Press the right arrow until you get to the **Accessory Mix** screen. Press **OK**.

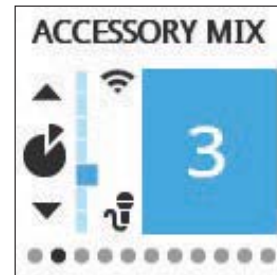

3. Press the **up or down arrow button** to change the mix.

For more information see your Remote Assistant's user guide.

## Option 2: Use the Nucleus Smart App

From the **Audio Sources** screen, you can open a screen that allows you to independently adjust the volume of the streamed audio and your sound processor microphones.

For more information see the Nucleus Smart App's user guide.

## Cautions

- Your wireless accessory transmits high frequency radio waves when switched on. When flying, place it in a flight-safe mode (e.g. turn it off) during takeoff and landing. Check with airline staff before flying if you are unsure.
- When wireless functionality is activated, your sound processor uses low-powered digitally coded transmissions in order to communicate with your wireless accessories. Although unlikely, nearby electronic devices may be affected. In that case, move the sound processor away from the affected electronic device.
- When using wireless functionality and the devices are affected by electromagnetic interference, move away from the source.
- Wireless accessories should be deactivated when not in use. If a processor remains in wireless streaming mode with no input, sounds will be significantly quieter.
- Cochlear True Wireless Accessories include an RF transmitter that operates in the range of 2.4–2.48 GHz. Turn off your wireless functionality in areas where radio frequency emission is prohibited.

## Warnings

- Refer to the user guide that was packaged with your wireless accessory for product-specific warnings and user information.

### Magnetic resonance imaging (MRI)



All external components of the Cochlear implant system (e.g. sound processors, remotes and related accessories) are MR Unsafe. The patient must remove all external components of the Cochlear implant system before entering a room where an MRI scanner is located.

Full MRI safety information is available at [www.cochlear.com/warnings](http://www.cochlear.com/warnings) or by calling your regional Cochlear office (contact numbers available at the end of this document).

## Care and maintenance

### Wireless accessory care

- Clean your wireless accessory using a damp cloth. Never use household cleaning products (washing powder, soap, etc.) or alcohol to clean the device.
- When your wireless accessory is not in use, turn it off and store it safely.
- Protect your wireless accessory from excessive moisture (bathing, swimming) and heat (radiator, car dashboard).
- Protect it from excessive shock and vibration.
- Protect the microphone and charger sockets from debris and dirt.
- When your TV Streamer is not being used for extended periods, unplug the power supply from the wall socket.

### Charger care

Please observe the following if the product is supplied with a charger.

- Do not attempt to charge your product with anything other than the AC adapter provided. The use of other chargers may damage or destroy the product and could be dangerous. Use of other chargers may invalidate any approval or void the warranty.
- For availability of approved accessories, please check with your hearing care professional.
- Charge the product according to the instructions provided.

## Built-in battery care

- The Phone Clip and Mini Microphone are powered by a rechargeable battery.
- A new battery performs optimally after two or three complete charge and discharge cycles.
- The battery can be charged and discharged hundreds of times, but will eventually wear out.
- Unplug the charger from the mains socket and the product when not in use.
- If left unused, a fully charged battery will lose its charge over time.
- Leaving the product in hot places will reduce the battery's capacity and service life.
- A product with a cold battery may not work temporarily, even if fully charged. Battery performance is particularly limited in temperatures well below freezing.



## Certification

Cochlear Bone Anchored Solutions AB, Mölnlycke Sweden is the legal manufacturer of the Cochlear Wireless Accessories.

Cochlear Limited have tested and verified the use of the Cochlear Wireless Accessories with the Nucleus 6 and Nucleus 7 Systems.

## Legal statement

The statements made in this guide are believed to be true and correct as of the date of publication. However, specifications are subject to change without notice.

© Cochlear Limited 2017





# Hear now. And always

## **Cochlear True Wireless Accessories:**

 **Cochlear Bone Anchored Solutions AB** Konstruktionsvägen 14, SE - 435 33 Mölnlycke, Sweden  
Tel: +46 31 792 44 00 Fax: +46 31 792 46 95

## **Nucleus Sound Processor Systems:**

 **Cochlear Ltd** (ABN 96 002 618 073) 1 University Avenue, Macquarie University, NSW 2109, Australia  
Tel: +61 2 9428 6555 Fax: +61 2 9428 6352

**Cochlear Ltd** (ABN 96 002 618 073) 14 Mars Road, Lane Cove, NSW 2066, Australia  
Tel: +61 2 9428 6555 Fax: +61 2 9428 6352

## **Regional Offices:**

 **Cochlear Deutschland GmbH & Co. KG** Karl-Wiechert-Allee 76A, 30625 Hannover, Germany  
Tel: +49 511 542 770 Fax: +49 511 542 7770

**Cochlear Americas** 13059 E Peakview Avenue, Centennial, CO 80111, USA  
Tel: +1 303 790 9010 Fax: +1 303 792 9025

**Cochlear Canada Inc** 2500-120 Adelaide Street West, Toronto, ON M5H 1T1, Canada  
Tel: +1 416 972 5082 Fax: +1 416 972 5083

**Cochlear AG** EMEA Headquarters, Peter Merian-Weg 4, 4052 Basel, Switzerland  
Tel: +41 61 205 0404 Fax: +41 61 205 0405

**Cochlear Europe Ltd** 6 Dashwood Lang Road, Bourne Business Park, Addlestone, Surrey KT15 2HJ, United Kingdom  
Tel: +44 1932 26 3400 Fax: +44 1932 26 3426

**Cochlear Benelux NV** Schaliënhoeverdreef 20 i, B-2800 Mechelen, Belgium  
Tel: +32 15 79 55 11 Fax: +32 15 79 55 70

**Cochlear France S.A.S.** 135 Route de Saint-Simon, 31035 Toulouse, France  
Tel: +33 5 34 63 85 85 (International) or 0805 200 016 (National) Fax: +33 5 34 63 85 80

**Cochlear Italia S.r.l.** Via Larga 33, 40138 Bologna, Italy  
Tel: +39 051 601 53 11 Fax: +39 051 39 20 62

**Cochlear Nordic AB** Konstruktionsvägen 14, 435 33 Mölnlycke, Sweden  
Tel: +46 31 335 14 61 Fax: +46 31 335 14 60

## **Cochlear Tıbbi Cihazlar ve Sağlık Hizmetleri Ltd. Şti.**

Çubuklu Mah. Boğaziçi Cad., Boğaziçi Plaza No: 6/1, Kavacık, TR-34805 Beykoz-Istanbul, Turkey  
Tel: +90 216 538 5900 Fax: +90 216 538 5919

**Cochlear (HK) Limited** Room 1204, 12/F, CRE Building, No 303 Hennessy Road, Wanchai, Hong Kong SAR  
Tel: +852 2530 5773 Fax: +852 2530 5183

**Cochlear Korea Ltd** 1st floor, Cheongwon Building 33, Teheran-ro 8 gil, Gangnam-gu, Seoul, Korea  
Tel: +82 2 533 4450 Fax: +82 2 533 8408

## **Cochlear Medical Device (Beijing) Co., Ltd**

Unit 2208-2212, Tower B, Gemdale Building, 91 Jianguo Road, Chaoyang District, Beijing 100022, P.R. China  
Tel: +86 10 5909 7800 Fax: +86 10 5909 7900

## **Cochlear Medical Device Company India Pvt. Ltd.**

Ground Floor, Platina Building, Plot No C-59, G-Block, Bandra Kurla Complex, Bandra (E), Mumbai – 400 051, India  
Tel: +91 22 6112 1111 Fax: +91 22 6112 1100

**株式会社日本コクレア (Nihon Cochlear Co Ltd)** 〒113-0033 東京都文京区本郷2-3-7 お茶の水元町ビル  
Tel: +81 3 3817 0241 Fax: +81 3 3817 0245

## **Cochlear Middle East FZ-LLC**

Dubai Healthcare City, Al Razi Building 64, Block A, Ground Floor, Offices IR1 and IR2, Dubai, United Arab Emirates  
Tel: +971 4 818 4400 Fax: +971 4 361 8925

## **Cochlear Latinoamérica S.A.**

International Business Park, Building 3835, Office 403, Panama Pacifico, Panama  
Tel: +507 830 6220 Fax: +507 830 6218

## **Cochlear NZ Limited**

Level 4, Takapuna Towers, 19-21 Como St, Takapuna, Auckland 0622, New Zealand  
Tel: + 64 9 914 1983 Fax: 0800 886 036

[www.cochlear.com](http://www.cochlear.com)

ACE, Advance Off-Stylet, AOS, AutoNRT, Autosensitivity, Beam, Button, Carina, Cochlear, コクレア, Codacs, Contour, Contour Advance, Custom Sound, ESPrit, Freedom, Hear now. And always, Hugfit, Hybrid, inHear, Invisible Hearing, Kanso, MET, MP3000, my-Cochlear, NRT, Nucleus, 科利耳, Off-Stylet, Slimline, SmartSound, Softip, SoftWear, SPrit, True Wireless, the elliptical logo and Whisper are either trademarks or registered trademarks of Cochlear Limited. Ardiun, Baha, Baha SoftWear, BCDrive, DermaLock, EveryWear, Vistafix and WindShield are either trademarks or registered trademarks of Cochlear Bone Anchored Solutions AB. Bluetooth is a registered trademark of Bluetooth SIG.

© Cochlear Limited 2017

D963695 ISS4 MAR17

